

TECHNICAL INFORMATION

CASING

SIZE:	9 5/8 "
NOMINAL WEIGHT:	53.50 lb/ft
WALL THICKNESS:	0.545 "
THREADS PER INCH:	5

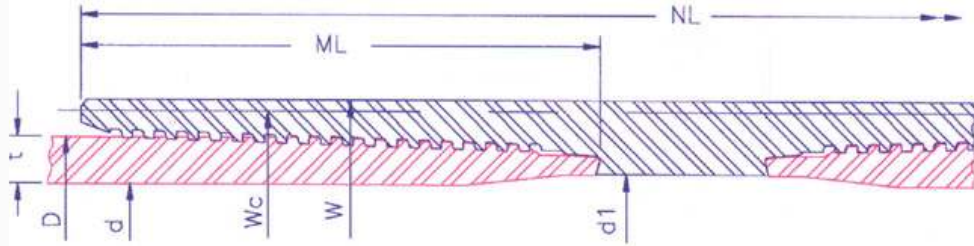

P I P E B O D Y	OUTSIDE DIA.(in)D	9.625	INSIDE DIA.(in) d	8.535	DRIFT DIA. (in)					8.379	PLAIN END WT (lb/ft)		52.85
	GRADE			K55	N80	L80	C90	C95	P110	Q125	150		
	COLLAPSE RESISTANCE (psi)			5130	6620	6620	7110	7340	7950	8440	8960		
	INTERNAL YIELD PRESSURE (psi)			5450	7930	7930	8920	9410	10900	12390	14860		
	BODY YIELD STRENGTH (kips)			855	1244	1244	1399	1477	1710	1943	2332		
	ULTIMATE STRENGTH (kips)			1477	1555	1477	1555	1632	1943	2099	2487		
	YIELD TORQUE (ft/lb)			176800	257200	257200	289400	305400	353700	401900	482300		

RECOMMENDED MAKEUP TORQUE USING A THREAD COMPOUND WITH FRICTION CORRECTION FACTOR OF 1.0											
M A K E U P	REGULAR	MINIMUM (ft/lb)	12100	14400	14400	14400	14400	14400	14400	14400	14400
		OPTIMUM (ft/lb)	13400	15900	15900	15900	15900	15900	15900	15900	15900
		MAXIMUM (ft/lb)	14700	17400	17400	17400	17400	17400	17400	17400	17400
	SPECIAL CLEARANCE	MINIMUM (ft/lb)	12100	14400	14400	14400	14400	14400	14400	14400	14400
		OPTIMUM (ft/lb)	13400	15900	15900	15900	15900	15900	15900	15900	15900
		MAXIMUM (ft/lb)	14700	17400	17400	17400	17400	17400	17400	17400	17400

C O N N E C T I O N	COLLAPSE RESISTANCE (psi)			5130	6620	6620	7110	7340	7950	8440	8960
	INTERNAL YIELD PRESSURE (psi)			5450	7930	7930	8920	9410	10900	12390	14860
	MAXIMUM LOAD OF REG. COUPLING FACE (kips)			723	1051	1051	1183	1249	1446	1643	1971
	MAXIMUM LOAD OF S.C. COUPLING FACE (kips)			267	388	388	436	461	533	606	727
	PARTING LOAD (kips)										
	REGULAR COUPLING O.D.			1145	1329	1285	1386	1458	1718	1890	2251
	SPECIAL CLEARANCE COUPLING O.D.			898	945	898	945	992	1181	1276	1512
				OUTSIDE DIA.(in)	INSIDE DIA.(in)	WEIGHT (lb)		JOINT EFFICENCY (%)		30' JOINT MUD DISPLACEMENT (in ³)	
	REGULAR COUPLING			W	10.650	8.947	68.40		117		5779
	SPECIAL CLEARANCE COUPLING			Wc	10.142	8.947	37.91		64		5672
	LENGTH OF COUPLING (in)			NL	12.971						
MAKE UP LOSS (in)			ML	5.545							

The above information is for reference only. The information is subject to change or modification without notice. Please contact HSC for the latest information